

92

AREA STATEMENT		106310.62	SQ.FT
TOTAL SITE AREA		11812.29	SQ. YDS
		2.44	ACRE
NO. OF FLATS		140.00	(2BHK)
TOTAL NO. OF FLATS IN BLOCK-01 (2BHK)		16.00	(3BHK)
TOTAL NO. OF FLATS IN BLOCK-02 (EWS)		140.00	+
TOTAL FLATS		16.00	EWS
AREA UTILIZED			
AREA UNDER BLOCK-01 (175 nos) 2BHK			
GROUND + 03 FLOORS		2.00	nos.
NO. OF FLAT ON ONE FLOOR		1750.16	sq.ft.
AREA OF ONE FLOOR		1750.16	X 4 = 7000.64
ADDITIONAL AREA OF DUCT & RAMP		81.13	SQ.FT.
TOTAL AREA UNDER BLOCK-01		7000.64	+ 81.13 = 7081.75
TOTAL AREA UNDER ALL BLOCK OF TYPE BLOCK-01		7081.75	X 17.5 = 123930.98
AREA UNDER BLOCK-02 (1 nos) EWS		4.00	nos.
GROUND + 03 FLOORS		1149.75	sq.ft.
NO. OF FLAT ON ONE FLOOR		1149.75	X 4 = 4599.00
AREA OF ONE FLOOR		75.25	SQ.FT.
ADDITIONAL AREA OF DUCT & RAMP		75.25	+
TOTAL AREA UNDER BLOCK-02		75.25	= 4599.00 = 4674.25
TOTAL AREA UNDER BLOCK-02			
AREA UNDER BLOCK-03 (1 nos) MEETING HALL			
GROUND + 01 FLOORS		1377.50	sq.ft.
NO. OF FLOOR		1377.50	X 2 = 2755.00
AREA OF BLOCK			
F.A.R. ACHIEVED		123930.98	+ 4674.25 = 2755.00
		131360.23	/ 106310.62 = 1.24 %
PARKING DETAIL			
REQUIRED E.C.S.		78.00	E.C.S.
AREA OF PARKING-01		9435.00	SQ.FT.
AREA OF PARKING-02		1232.00	SQ.FT.
AREA OF PARKING-03		8542.78	SQ.FT.
TOTAL PARKING AREA		19209.78	SQ.FT.
TOTAL PROPOSED E.C.S. ON SITE		19209.78	/ 2385
		81	E.C.S.
GREEN AREA DETAIL			
AREA OF GREEN-01		4578.50	SQ.FT.
AREA OF GREEN-02		3487.50	SQ.FT.
AREA OF GREEN-03		10427.01	SQ.FT.
TOTAL GREEN AREA ON SITE		18493.01	SQ.FT.
			17 %
GROUND COVERAGE			
GROUND COVERAGE UNDER BLOCK-01		1750.16	X 17.5 = 30627.8
GROUND COVERAGE UNDER BLOCK-02		1149.75	sq.ft.
GROUND COVERAGE UNDER BLOCK-03		1377.50	sq.ft.
TOTAL		33155.05	sq.ft.
TOTAL GROUND COVERAGE		33155.05	/ 106310.62 = 31.19 %
TOTAL LENGTH OF BOUNDARY WALL		1354.00	RF.

PROJECT: REVISED GROUP HOUSING OF PALM MEADOWS AT VILLAGE KHANPUR, KHARAR DISTT. S A S NAGAR (MOHALI) PUNJAB

DEVELOPERS: UBBER BUILDTECH PVT. LTD.

TITLE: SITE PLAN

ARCHITECT: ARCHITECT OWNER

ARCHITECTS: Approved Drawn: Mukesh

Date:

SCALE: NTS

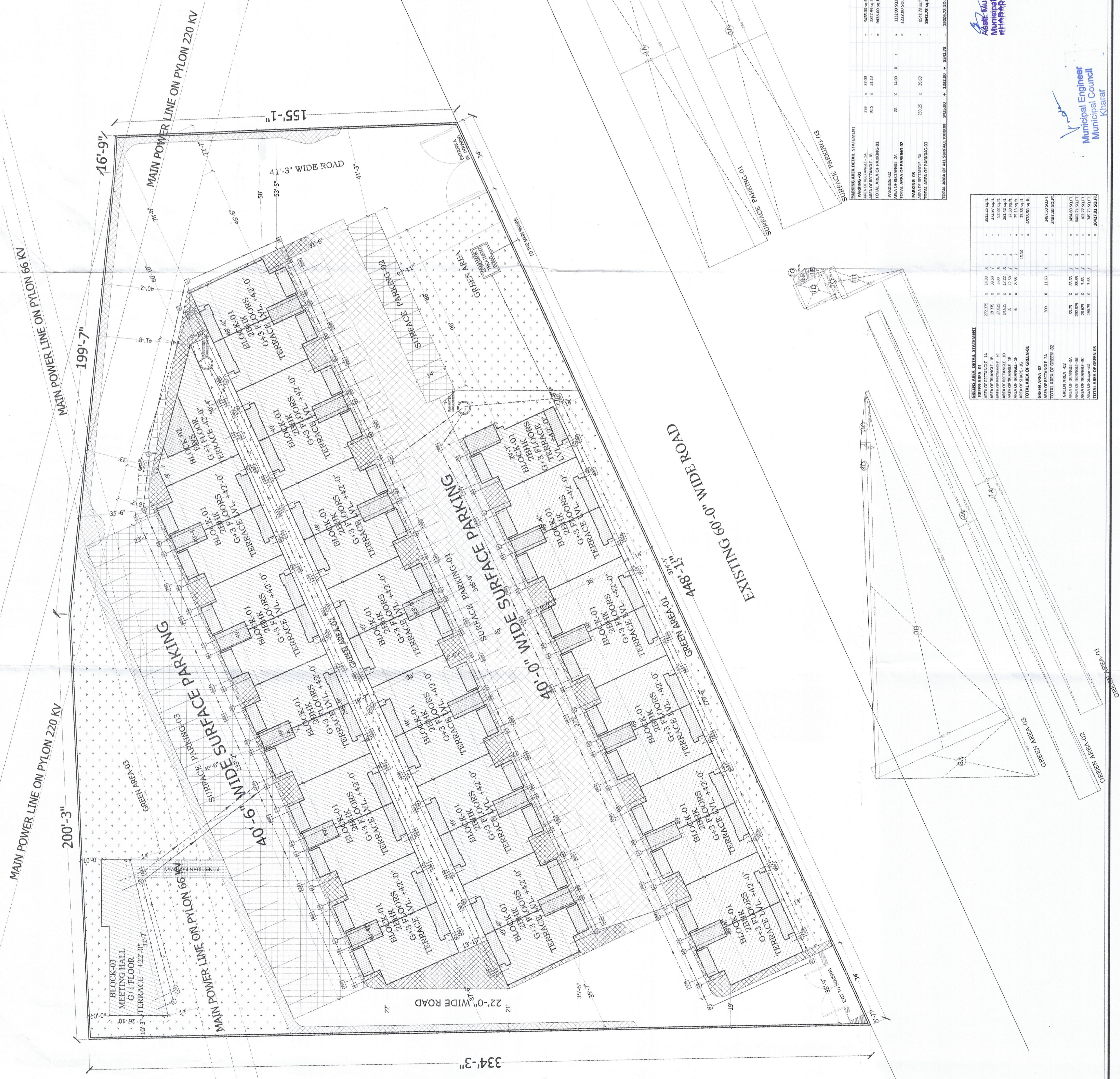

GREEN AREA STATEMENT

GREEN AREA-01	4578.50	X	1	=	4578.50
GREEN AREA-02	3487.50	X	1	=	3487.50
GREEN AREA-03	10427.01	X	1	=	10427.01
TOTAL AREA OF GREEN-01					4578.50
TOTAL AREA OF GREEN-02					3487.50
TOTAL AREA OF GREEN-03					10427.01
TOTAL AREA OF GREEN-04					14793.01

PARKING AREA STATEMENT

PARKING-01	9435.00	X	1	=	9435.00
PARKING-02	1232.00	X	1	=	1232.00
PARKING-03	8542.78	X	1	=	8542.78
TOTAL AREA OF PARKING-01					9435.00
TOTAL AREA OF PARKING-02					1232.00
TOTAL AREA OF PARKING-03					8542.78
TOTAL AREA OF PARKING-04					19209.78

GREEN AREA STATEMENT

GREEN AREA-01	4578.50	X	1	=	4578.50
GREEN AREA-02	3487.50	X	1	=	3487.50
GREEN AREA-03	10427.01	X	1	=	10427.01
TOTAL AREA OF GREEN-01					4578.50
TOTAL AREA OF GREEN-02					3487.50
TOTAL AREA OF GREEN-03					10427.01
TOTAL AREA OF GREEN-04					14793.01

PARKING AREA STATEMENT

PARKING-01	9435.00	X	1	=	9435.00
PARKING-02	1232.00	X	1	=	1232.00
PARKING-03	8542.78	X	1	=	8542.78
TOTAL AREA OF PARKING-01					9435.00
TOTAL AREA OF PARKING-02					1232.00
TOTAL AREA OF PARKING-03					8542.78
TOTAL AREA OF PARKING-04					19209.78

GREEN AREA STATEMENT

GREEN AREA-01	4578.50	X	1	=	4578.50
GREEN AREA-02	3487.50	X	1	=	3487.50
GREEN AREA-03	10427.01	X	1	=	10427.01
TOTAL AREA OF GREEN-01					4578.50
TOTAL AREA OF GREEN-02					3487.50
TOTAL AREA OF GREEN-03					10427.01
TOTAL AREA OF GREEN-04					14793.01

APPROVED BY MUNICIPAL ENGINEER MUNICIPAL COUNCIL KHARAR